



Kawasaki ZX-6 R (2007)

Slip-On & Slip-On Street Legal Exhaust System

# Akrapovic Slip-On & Slip-On Street Legal Exhaust System

for the Kawasaki ZX-6 R (2007)

The ZX 6-R, Kawasaki's speedster in the 600 class, is definitely a head-turner. To improve its sleek looks even further we have developed an Akrapovic SLIP-ON system which fits smoothly into the lines of the Kawasaki. The Akrapovic SLIP-ON exhaust system is designed for riders who are looking for an excellent combination of aesthetics, quality and price. System is available in street legal and sportier open version.

## PERFORMANCE

Measurements of the Akrapovic SLIP-ON system on the KAWASAKI ZX 6-R (without noise damper):

Power & Torque: Akrapovic power curve follows the stock curve up to 6000 rpm, and then shows an noticeable increase which extends right into the overrev range. The ZX 6-R receives 117,8 HP at 14325 rpm, which is 3 HP more than with stock exhaust system. The torque curve is increased throughout the entire rpm range and gives more easy to drive engine characteristics.

## CONFIGURATION

The Akrapovic SLIP-ON system is made of stainless steel (link pipe), titanium (complete muffler), and the carbon-fiber outlet cap cover. All that gives the system a stylish racing look. A cylindrical stainless steel link pipe is connected to the muffler with a sleeve joint, secured with silicon-shielded tensioning springs. At the other end the link pipe is attached to the stock header tube with a stock metal clamp. It is attached to the frame with a special Akrapovic carbon-fiber clamp.

	PERFORMANCE		
	stock	AKRAPOVIC	max. increased power
max. rear wheel power HP / rpm (measured on Dynojet ATV)	114.9 / 14200	117.8 / 14325	3 / 14325

	CONFIGURATION		
	header tubes	collector	link pipe
material	-	-	STAINLESS STEEL
tube shape	-	-	CYLINDRICAL

interference crossover tubes	-	lambda sensor	NO
header tube inner sleeves	-	header tube flanges	-
header tubes - collector connection	-	collector / header tube - link pipe connection	STOCK METAL CLAMP +STOCK GRAPHIT GASKET
link pipe - muffler connection	SLEEVE JOINT + SILICON SHIELDED SPRINGS	muffler inlet cap / outlet cap	TITANIUM / CARBON-FIBER
muffler metal interior	TITANIUM	muffler outer sleeve	TITANIUM
muffler clamp	CARBON-FIBER	muffler bracket	MUFFLER HEAT SHIELD BRACKETS: STAINLESS STEEL LICENCE PLATE HOLDER BRACKET: STAINLESS STEEL
muffler insert	EU	NOISE DAMPER	NO (STOCK)
	US	-	NO (STOCK)
		heat shield	NO (STOCK)
		catalytic converter	NO (STOCK)

	ADDITIONAL DATA				
	stock	AKRAPOVIC		difference	
weight comparison (kg)	/	S.S. link pipe	TITANIUM link pipe	stock - S.S.	stock - titanium
		/	-	/	-
noise measurements (dB / rpm)	stock		AKRAPOVIC		
	95 / 7000		101.9 / 7000 (homologated)		
possibility of periodic service without removing A.E.S.	oil		oil filter		
	YES		YES		
legal for street use	NO / YES (homologated)				

Technical specifications of Akrapovic exhaust systems and related products subject to change without notice.

Product code: S-K6SO5-ACT  
S-K6SO5-HACT Homologated

# Akrapovic Slip-On & Slip-On Street Legal Exhaust System for the Kawasaki ZX-6 R (2007)



Akrapovic Exhaust System Technology copyright 2007, all rights reserved

Road  
Program

Product code: S-K6SO5-ACT  
S-K6SO5-HACT Homologated

# Akrapovic Slip-On & Slip-On Street Legal Exhaust System for the Kawasaki ZX-6 R (2007)



Akrapovic Exhaust System Technology copyright 2007, all rights reserved

Road  
Program

Product code: S-K6SO5-ACT  
S-K6SO5-HACT Homologated

# Akrapovic Slip-On Street Legal Exhaust System for the Kawasaki ZX-6 R (2007)

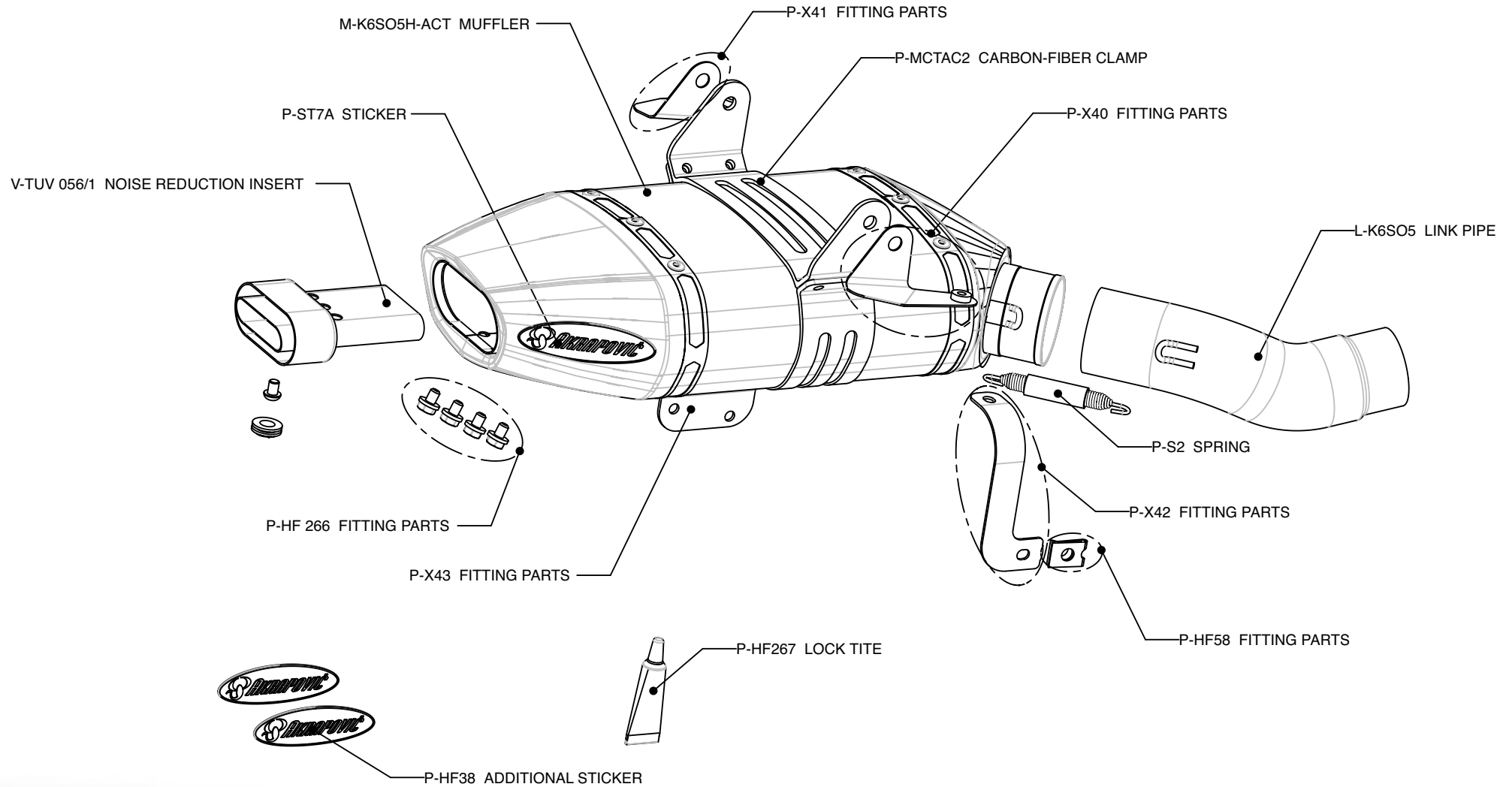

Akrapovic Exhaust System Technology copyright 2007, all rights reserved

Road Program

Product code: S-K6SO5-HACT Homologated



# Akrapovic Slip-On & Slip-On Street Legal Exhaust System for the Kawasaki ZX-6 R (2007)

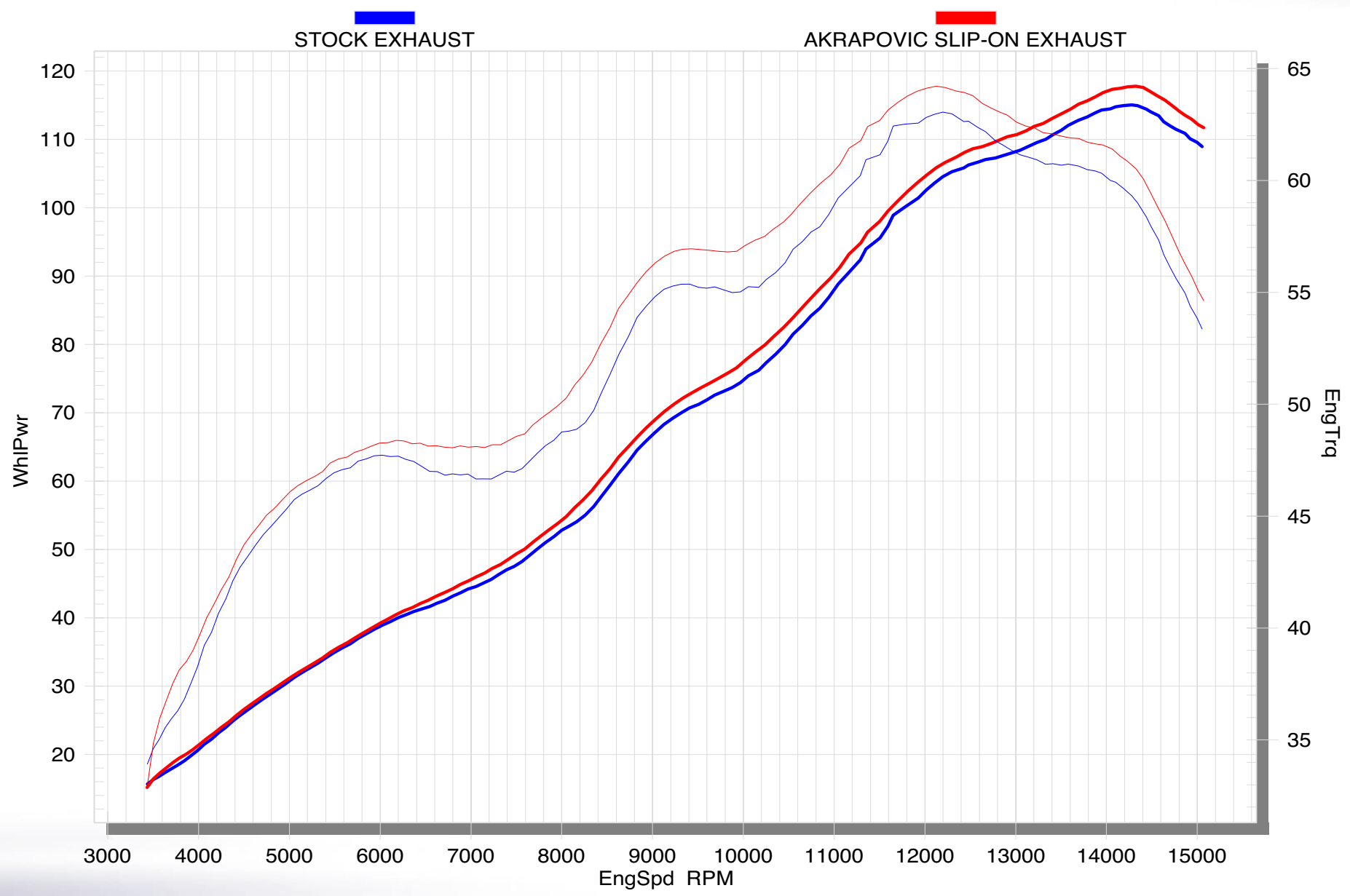

Road Program

Product code: S-K6SO5-ACT  
S-K6SO5-HACT Homologated



Akrapovic Exhaust System Technology copyright 2007, all rights reserved